



HSL Filter Housing

- sanitary liquid

- Single element sanitary liquid housing
- Designed specifically for the food and beverage and pharmaceutical industry
- Sanitary vent and tri-clamp connections as standard
- Sanitary tri-clamp body closure as standard



Specification

Materials of Construction

- Housing: 316L Stainless Steel
- Seals: Silicone FDA

Surface Finish

- Internal: Polished 0.4 µm Ra
- External: Polished 0.25 µm Ra

All finishes pickled & passivated.

Welding

All assembly welds are full penetration. All welds are crevice and undercut free.

Weld finish & detail drawings available upon request.

Certification

Supplied as standard with vessel inspection certificate.

Material Test Certification

EN10204 3.1 supplied upon request.

Design Code

Housings designed in accordance with the European Council Pressure Equipment Directive (PED) 97/23/EC and the UK statutory Pressure Equipment Regulations (PER) 1999 N° 2001.

PED / PER conformity assessments based on Fluid Group 2 Gas (harmless) including steam. Only housings over PS.V 50 bar / litres bear the CE mark.

Design Basis

ASME VIII Division 1.

| Working Condition PED 97/23/EC | | | Maximum Pressure | | |
|------------------------------------|--------------|-----------------|--------------------------|--------------------------|--------------------------|
| Fluid Group | State | Temperature | 011 | 012 | 013 |
| Non Dangerous | Liquid / Gas | 150 °C (302 °F) | 10.00 barg (145.03 psig) | 10.00 barg (145.03 psig) | 10.00 barg (145.03 psig) |
| Dangerous | Liquid / Gas | 150 °C (302 °F) | 5.00 barg (72.51 psig) | 5.00 barg (72.51 psig) | 5.00 barg (72.51 psig) |
| PED Conformity Assessment Category | | | SEP | SEP | CAT I |
| Volume (litres) | | | 2.9 | 4.8 | 6.7 |

Physical Characteristics

| Bowl Height | Dimensions (mm) | | | Weight (Kg) | | |
|--------------|-----------------|-----|-----|-------------|------|-------|
| | 'A' | 'B' | 'C' | Bowl | Head | Total |
| 10" (250 mm) | 156 | 417 | 313 | 1.0 | 1.5 | 3.8 |
| 20" (500 mm) | 156 | 667 | 561 | 1.6 | 1.5 | 4.8 |
| 30" (750 mm) | 156 | 912 | 809 | 2.6 | 1.5 | 5.7 |

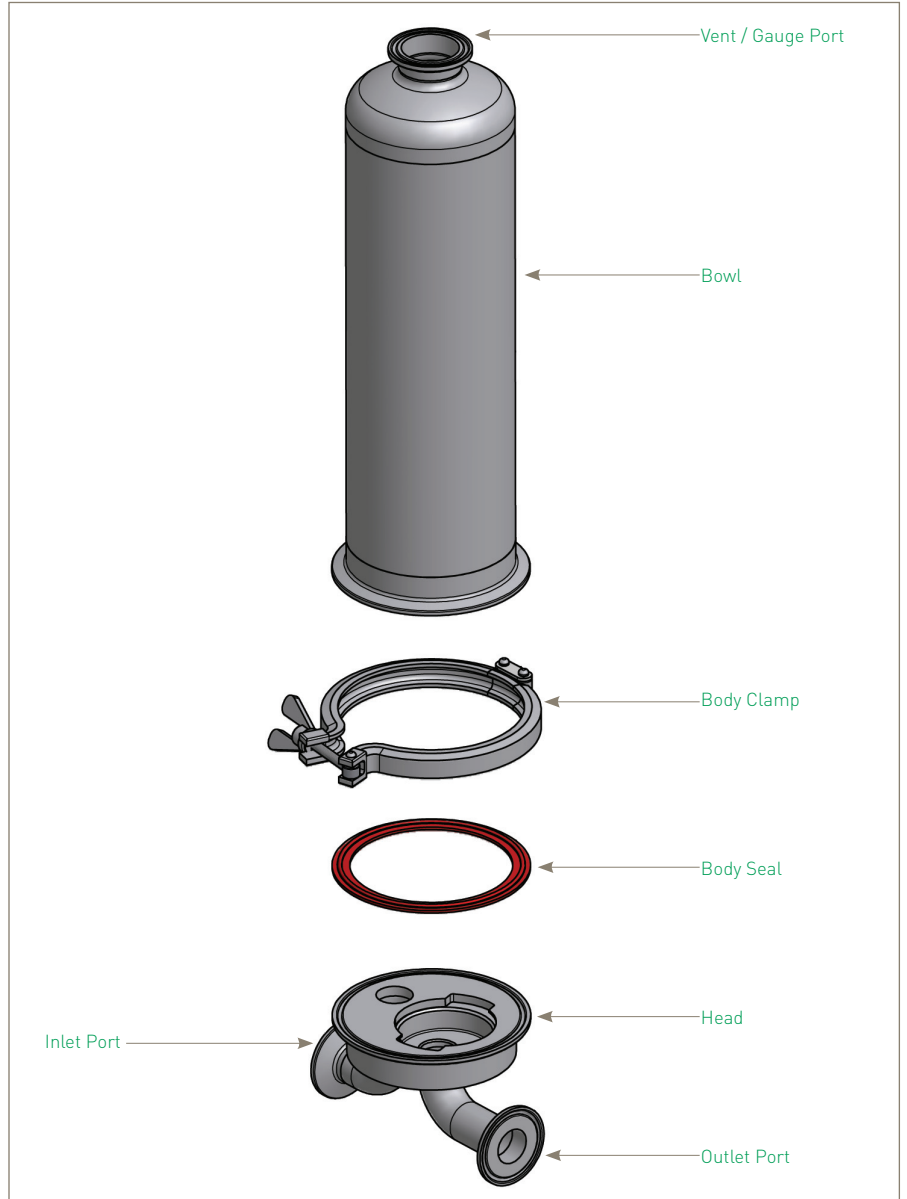
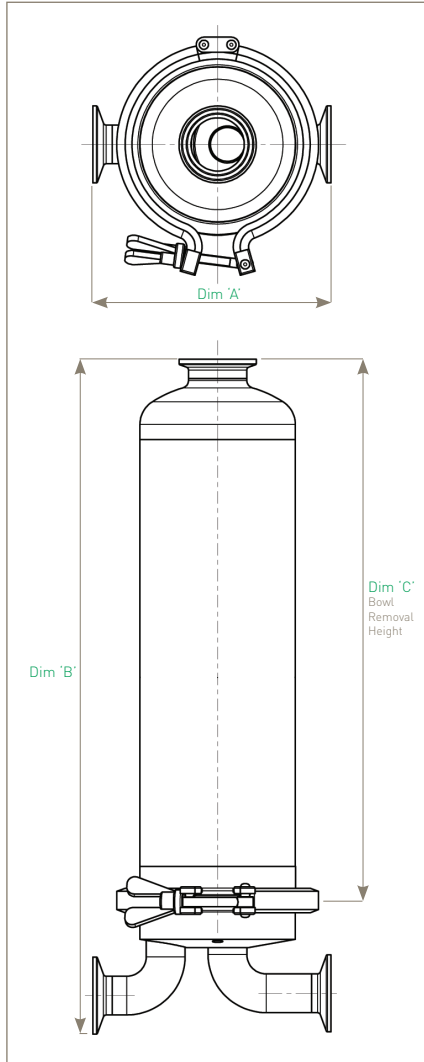

Ordering Information

HSL

01

-

-

| Code Vessel Class | Code Length (Nominal) | Code Connection Size | Code Standard | Code Cartridge | Code Seal |
|---------------------|--|------------------------|-----------------|------------------|-------------|
| CE Standard | 1 10" (250 mm) 2 20" (500 mm) 3 30" (750 mm) | B 1" (25.4 mm) | T Tri-Clamp | C 226 | S Silicone |

Note: For accessories, i.e. gauges, please contact Parker domnick hunter - Process Division for full availability.

For additional features, Parker domnick hunter offer this housing as part of its Standard PLUS Range. Please see HSL® datasheet for more information.

Parker domnick hunter has a continuous policy of product development and although the Company reserves the right to change specifications, it attempts to keep customers informed of any alterations. This publication is for general information only and customers are requested to contact our Process Filtration Sales Department for detailed information and advice on a products suitability for specific applications. All products are sold subject to the company's Standard conditions of sale.